

EMMCON

P-207, R K Sarani, Behala, Kolkata - 700 060
E-mail : subhasis900@gmail.com
Mobile : +91 98300 87646

TO WHOM IT MAY CONCERN

Location plan of proposed project "T.F. Residency" situated at Premises No. - 9, Ram Krishna Sarani, Ward- 129, Borough- XIV, P.S. - Parnasree, Kolkata- 700060 is shown below:

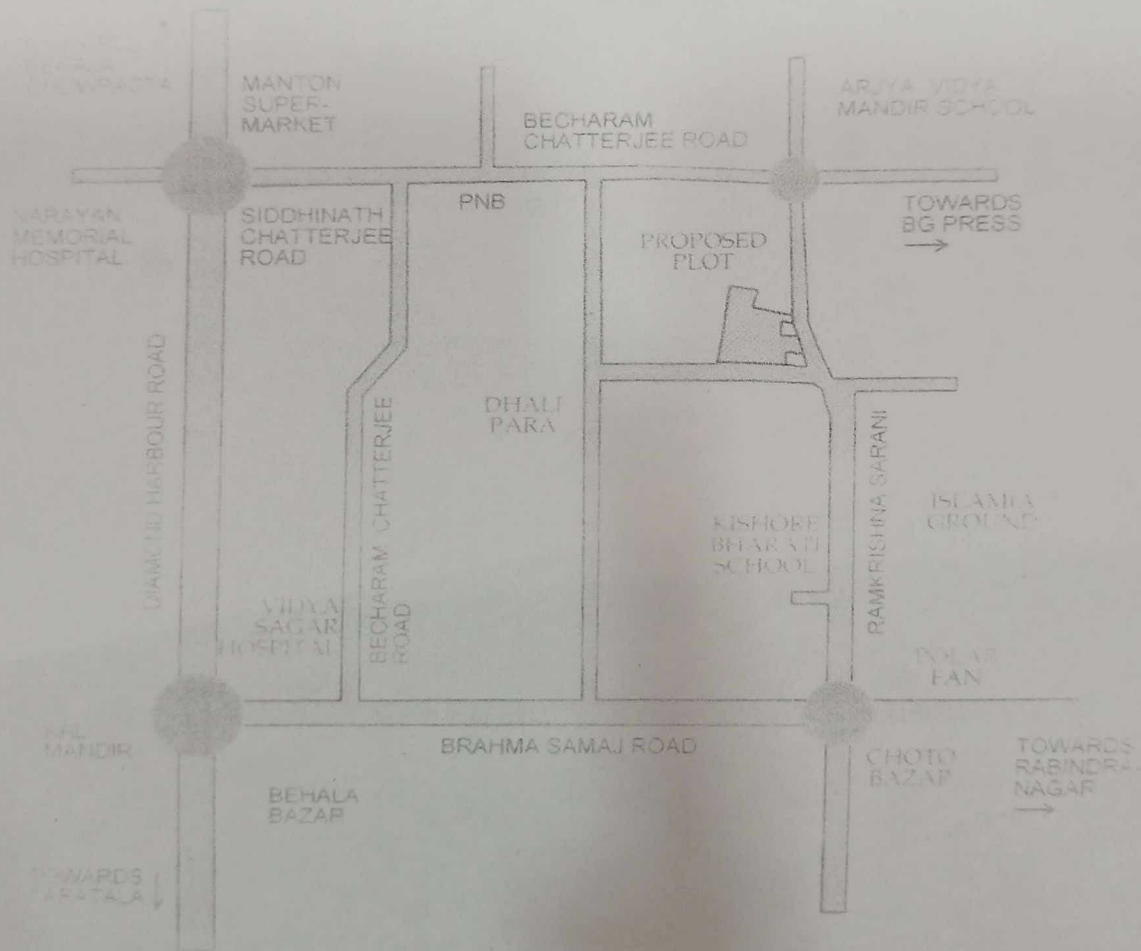

Latitude: 22°29'53.9"N
Longitude: 88°18'30.7"E

For M/s Emmcon
EMMCON

Partner

Subhasis Chatterjee
Partner